

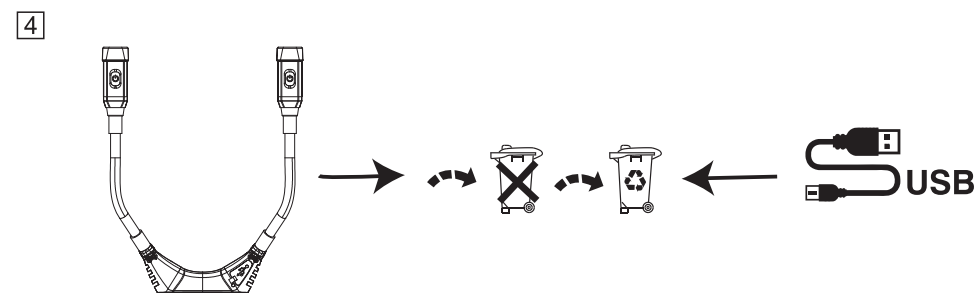

T9429USB

NECK LIGHT 300lm

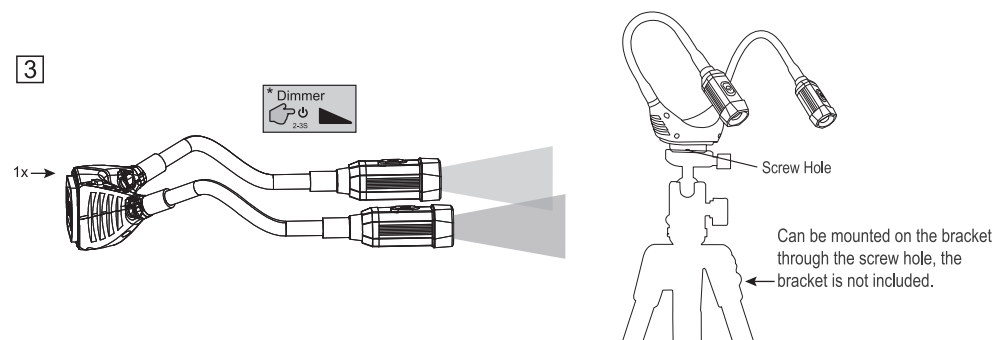
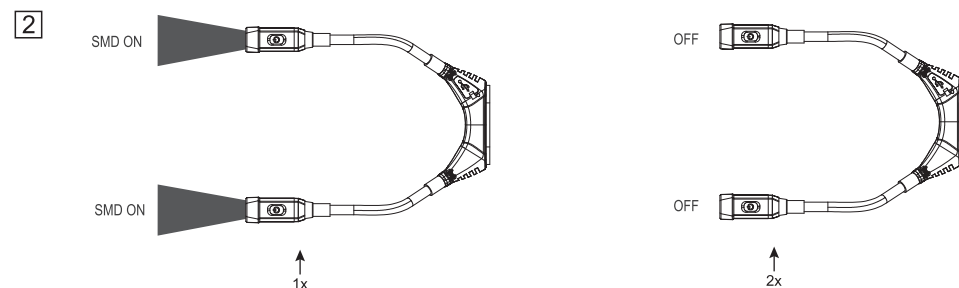
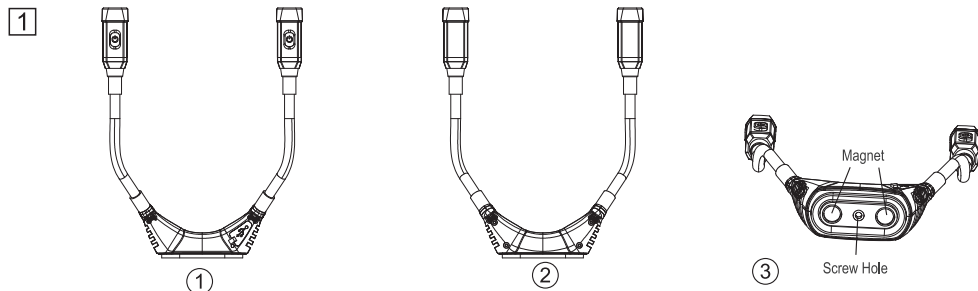

SAFETY PRECAUTIONS

- Do not use the lamp in the immediate vicinity of flammable materials or gases.
- Make sure that the lights are not covered during use.
- Only use the accessories included with the product for recharging your rechargeable workshop lamp.
- Keep the lamp out of reach of unauthorized persons, especially children.
- Do not point the light directly in your own or any other person's or animal's eyes.
- Always check the power cable before you charge. If the power cable is damaged, replace the cable.

RECHARGING BATTERY

- Completely charge the batteries before you first use the lamp.
- Plug the power supply into an 5V DC 1A power adapter.
- Plug the charger Type-C USB cable into the lamp Micro socket when the indicator turns to red and flashes.
- When charging, the indicator is red. Once the battery is completely charged, the indicator turns to green.
- Do not leave the battery without charge for an extended period. Deep discharge risks damaging the battery.
- The LED of this lamp is not replaceable. When the light source reaches its end of life, the whole lamp shall be replaced.
- Discarded electrical products must not be disposed of together with household waste. Please use recycling facilities. Ask your local authority for advices on recycling.



LED



MAX:300LM



0.49lbs

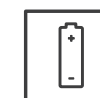

Polymer battery



5h run time



14° to 104°F



3.28ft



Magnet



USB interface



4h charge time